

*Appendix A*

---

*Certificate of Title*



**COMPUTER FREEHOLD REGISTER  
UNDER LAND TRANSFER ACT 1952**



**Search Copy**

R. W. Muir  
Registrar-General  
of Land

**Identifier** SA8D/754  
**Land Registration District** South Auckland  
**Date Issued** 30 May 1968

**Part-Cancelled**

**Prior References**  
SAPR262/10

---

**Estate** Fee Simple  
**Area** 37.9620 hectares more or less  
**Legal Description** Te Mata B2 Block

**Proprietors**

Whaitiri Williams as to a 1/2 share  
Neville Walter Williams as to a 1/4 share  
Suzanne Iris Lee Williams as to a 1/4 share

---

**Interests**

H728887 Gazette Notice acquiring part within land (3363 m<sup>2</sup>) for road pursuant to Section 11(1A) of the National Roads Act 1953 shall form part of State Highway No. 25 and vesting same in The Crown - 27.5.1987 at 9.27 am  
B032600.2 Mortgage to The National Bank of New Zealand Limited - 23.7.1991 at 1.30 pm

Blk. XIII Coromandel S. D.

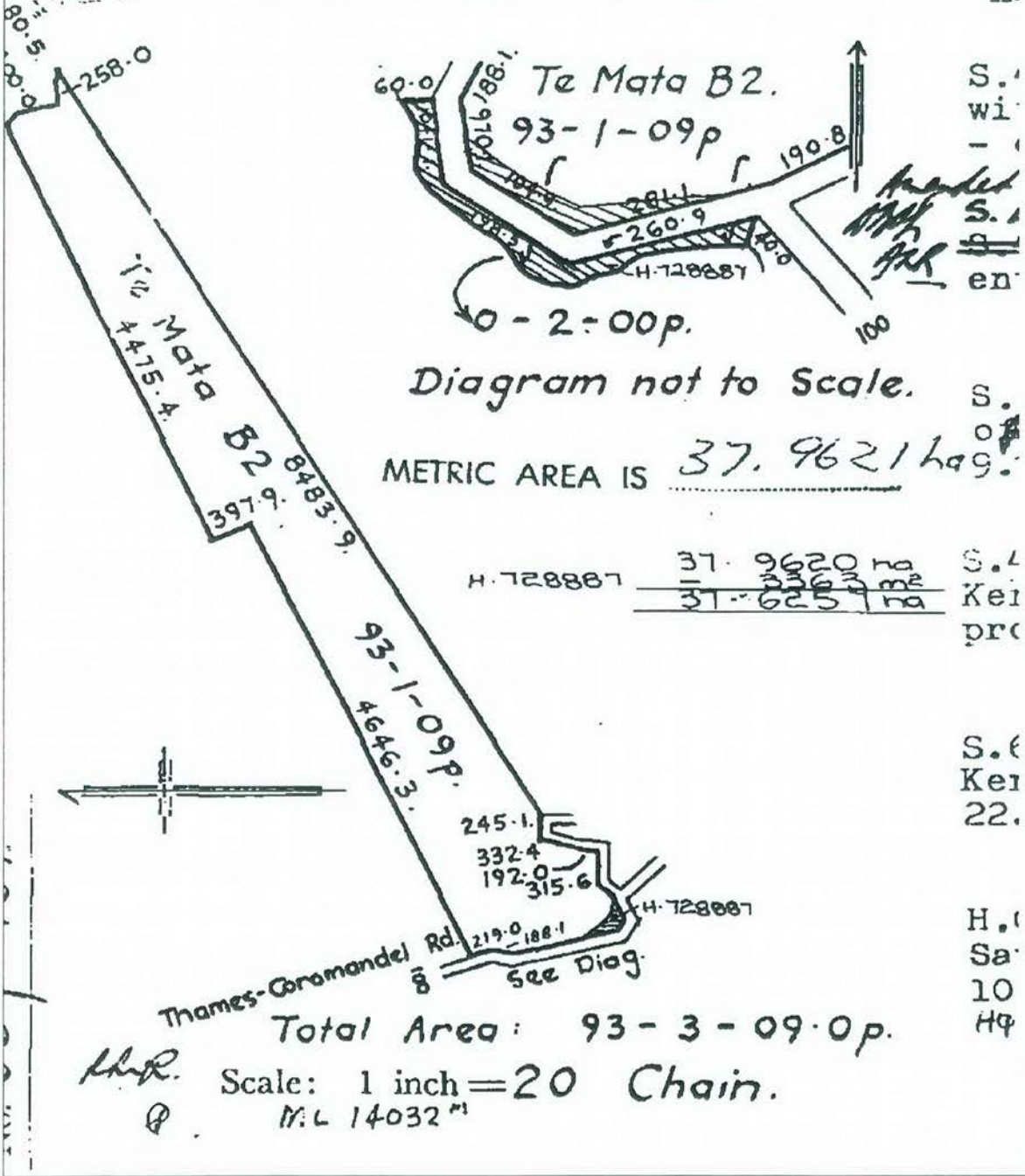

A:

S.4

wi

-

S.4

en

S.4

of

S.4

Kei

22.

H.1

Sa

10

Hq